

Technical Data

CIELO™ 2 Life BTE

Premium Features

- Programmable BTE instrument with optional ePocket™
- Fully digital 6-channel amplifier
- For mild to moderate and ski slope hearing losses
- Data logging
- High performance, automatic and adaptive directional microphone
- Automatic and adaptive feedback cancellation
- Automatic situation detection including music detection
- Adaptive noise reduction and speech enhancement in 6 channels
- Wind noise reduction
- 3 individual hearing programs available with optional ePocket™

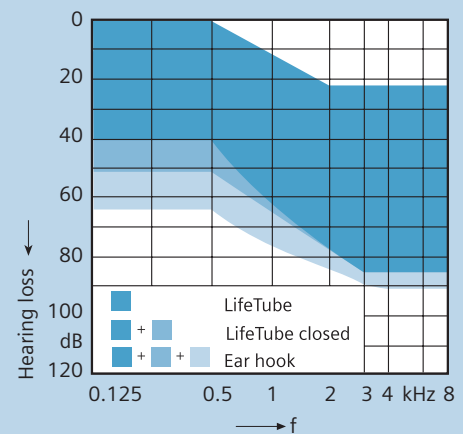

Additional Features

- Alert tones for low battery
- Battery compartment with ON/OFF switch
- Battery type 312
- Nanocoated housing

Optional features

- Available in the following colors: beige, brown, grey, granite, silver, black, pearl white, transparent, and translucent fun colors: purple, green, blue, orange and pink
- Life Fitting Set including LifeTubes, LifeTips, and other fitting accessories
- Small earhook

Technical Data

www.usa.siemens.com/hearing

SIEMENS

CIELO 2 Life BTE Technical Data

	2cc coupler Standard ANSI S3.22-2003	
	Standard Earhook	LifeTube*
Output Sound Pressure Level		
Peak	123 dB	123 dB
HF-Average OSPL 90	120 dB	112 dB
Gain (Input 50 dB)		
Peak	55 dB	45 dB
HF-Average	46 dB	39 dB
Reference test gain	43 dB	36 dB
Frequency Range		
Low frequency limit	180 Hz	100 Hz
High frequency limit	6100 Hz	5800 Hz
Total Harmonic Distortion		
500 Hz	1%	1%
800 Hz	1%	1%
1600 Hz	2%	2%
Equivalent Input Noise	25 dB	25 dB
AGC-O (CK = -21 dB)		
Attack time	4 ms	4 ms
Release time	100 ms	100 ms
Battery		
Type	312 cell zinc-air	312 cell zinc-air
Current Drain	0.8 mA	0.8 mA
Typical Life	~150 h	~150 h

Technical information for wireless function:

Operating frequencies: $f_{\text{low}} = 115 \text{ kHz}$, $f_{\text{high}} = 120 \text{ kHz}$;

Rated H-field strength (maximum): $-11,5 \mu\text{A/m}$ at 3 meters.

CIELO 2 Life BTE Basic Data

Basic Data w/Standard Earhook

Output Sound Pressure Level ($L_i = 90$ dB)

Maximum Gain ($L_i = 50$ dB)

ANSI S3.22-2003

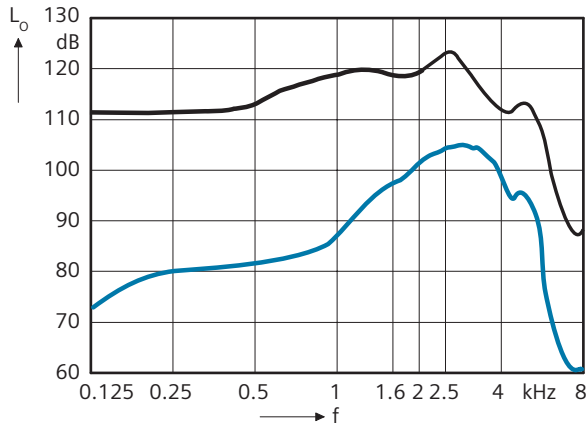

Frequency Response ($L_i = 60$ dB)

Basic Acoustic Response ($L_i = 60$ dB)

ANSI S3.22-2003

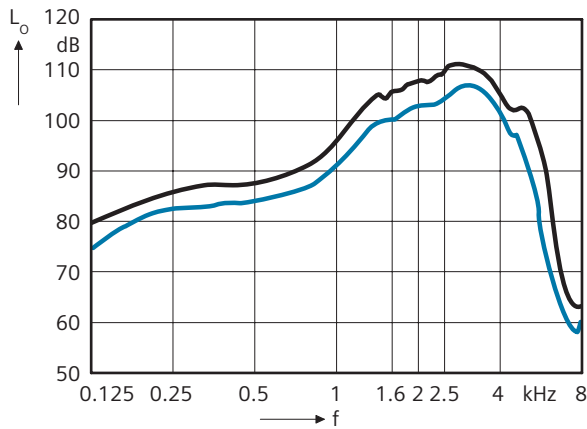

Effect of MPO (FOG, $f = 2$ kHz)

ANSI S3.22-2003

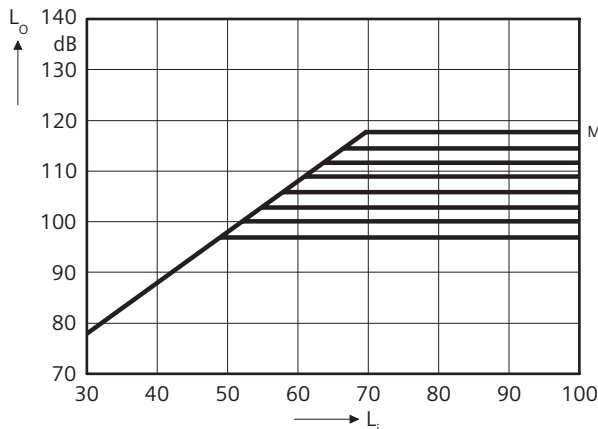

Basic Data with LifeTube™

Output Sound Pressure Level ($L_i = 90$ dB)

Maximum Gain ($L_i = 50$ dB)

ANSI S3.22-2003

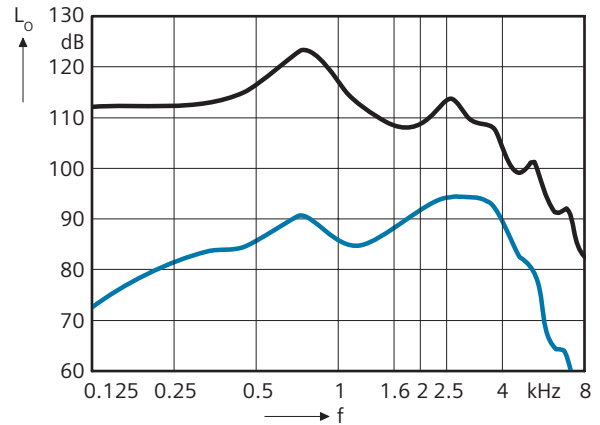

Frequency Response ($L_i = 60$ dB)

Basic Acoustic Response ($L_i = 60$ dB)

ANSI S3.22-2003

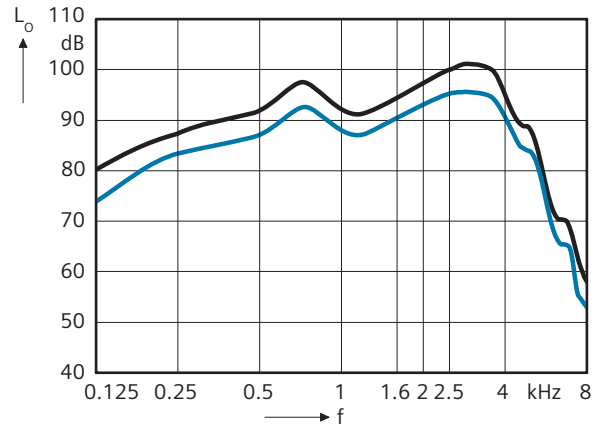

Effect of MPO (FOG, $f = 2$ kHz)

ANSI S3.22-2003

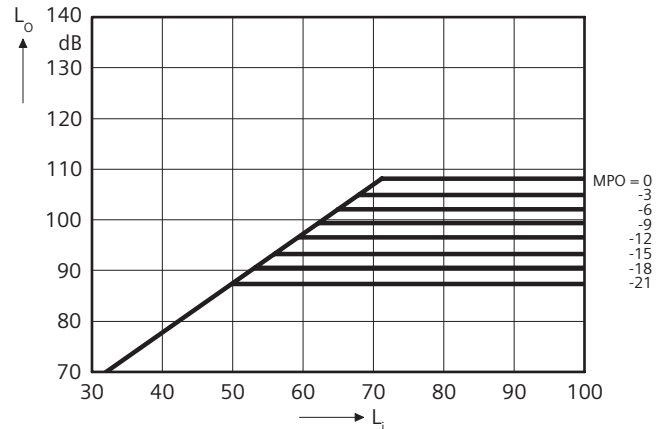

CIELO 2 Life BTE Fitting Information



Programming Socket

The programming socket lies under a flap just above the battery door. Use a suitable tool to open the flap. After the programming procedure is complete, close the flap using your fingernail.

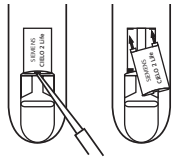

Changing the Typeplates

To mark the left and right side of the CIELO 2 Life instruments when fitting binaurally, exchange the housing colored typeplates on the inner curve of the instruments for blue (left) and red (right). Use a suitable tool to lift and remove the typeplate. Lock the two pins on the new typeplate into the openings and press gently into position with your finger.

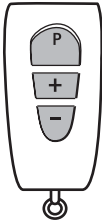

ePocket™

The CIELO 2 hearing system supports the use of ePocket™, a bi-directional remote control with read out function.

ePocket can change the hearing programs and the volume of CIELO 2. The ePocket read out function will display the current program, volume level and battery status of the instrument(s).

ePocket includes a cover and clip.

Life Fitting Set

The Life Fitting Set includes parts and special tools necessary for fitting CIELO 2 Life in a convenient carrying case. Refills for all parts are available through Siemens.

Siemens Hearing Instruments, Inc. locations

United States Headquarters/Northeast Manufacturing Facility:

10 Constitution Avenue, P.O. Box 1397, Piscataway, NJ 08855-1397 • (732) 562-6600 or (800) 766-4500

Midwest Sales Facility: (847) 808-1200 or (800) 333-9083

West Manufacturing Facility: (562) 404-4531 or (800) 998-9787

Technical Support for Software and Systems: (888) 231-1333

www.usa.siemens.com/hearing

Siemens Hearing Instruments

A Division of Siemens Canada Limited

320 Pinebush Road, Cambridge, Ontario, Canada N1T 1Z6 • (519) 622-5200 or (800) 663-0620

www.siemens.ca/hearing