

Technical Data

CENTRA Life BTE

Premium Features

- Digital 16-channel amplifier with 8 fully adjustable compression channels
- Programmable BTE instrument with SoundSmoothing™ technology, DataLearning™ technology, and e2e wireless™
- Optimized solution for binaural fitting
- For mild to moderate hearing losses
- Binaural program selection with e2e wireless
- High performance directional microphone, automatic and multi-channel adaptive operation
- Automatic and adaptive feedback cancellation
- Automatic situation detection with music detection
- Adaptive noise reduction and adaptive speech enhancement
- eWindScreen™, wind noise reduction system
- Professional and efficient fitting with the workflow oriented CONNEXX™ software

Standard Features

- SoundSmoothing technology
- DataLearning technology
- e2e wireless technology
- Battery compartment with ON/OFF switch
- Up to three hearing programs (only with ePocket™)
- Battery type 312
- Alerting tones for low battery voltage

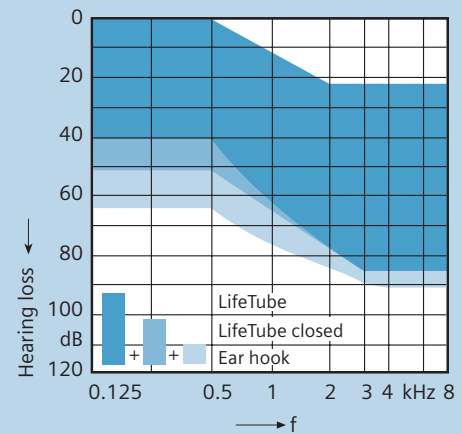

Options & Accessories

- Available in the following colors: beige, brown, grey, granite, silver, black, transparent, and translucent fun colors: purple, green, blue, orange and pink
- Life Fitting Set including LifeTubes, LifeTips and other fitting accessories, with refill packages available
- ePocket™, bi-directional remote control with read out function, program change and volume adjustment
- Earhook
- Eyeglass adapter

CENTRA Life BTE Technical Data

		2cc coupler Standard ANSI S3.22-2003	
		Standard Earhook	LifeTube*
Output Sound Pressure Level	Peak	123 dB	123 dB
	HF-Average OSPL 90	119 dB	112 dB
Gain (Input 50 dB)	Peak	55 dB	45 dB
	HF-Average	45 dB	39 dB
	Reference test gain	42 dB	36 dB
Frequency Range	Low frequency limit	180 Hz	100 Hz
	High frequency limit	6100 Hz	5800 Hz
Total Harmonic Distortion	500 Hz	1%	1%
	800 Hz	1%	1%
	1600 Hz	2%	2%
Equivalent Input Noise		25 dB	25 dB
AGC-O (CK = -21 dB)	Attack time	4 ms	4 ms
	Release time	100 ms	100 ms
Battery	Type	312 cell zinc-air	312 cell zinc-air
	Voltage	1.3 v	1.3 v
	Current Drain	0.8 mA	0.8 mA
	Typical Life	~150 h	~150 h

Technical information for e2e wireless function: Operating frequencies: $f_{\text{low}} = 115 \text{ kHz}$, $f_{\text{high}} = 120 \text{ kHz}$; Rated H-field strength (maximum): $-11,5 \mu\text{A/m}$ at 3 meters.

*Measured with LifeTube2

Measure instructions: Instrument in linear setting. Input signal: Sinus Burst; Frequency: 2500 Hz; Low Level: 33 dB; High Level: 60 dB; Interval: 250 ms; On; Time: 125 ms.

CENTRA Life BTE Basic Data

Basic Data with LifeTube™

Output Sound Pressure Level ($L_i = 90$ dB)
Maximum Gain ($L_i = 50$ dB)

IEC 118-7/A; ANSI S3.22-2003

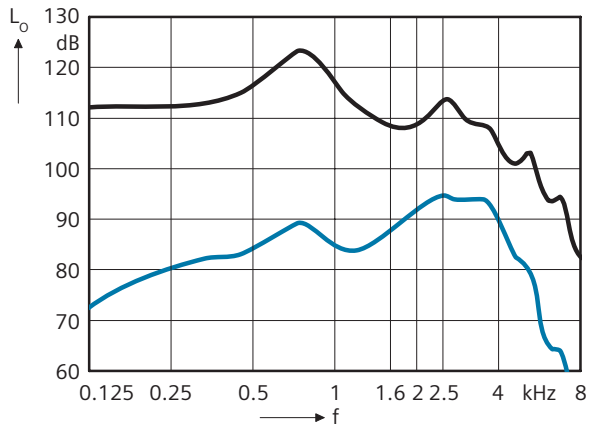

Frequency Response ($L_i = 60$ dB)
Basic Acoustic Response ($L_i = 60$ dB)

IEC 118-7/A1; ANSI S3.22-2003

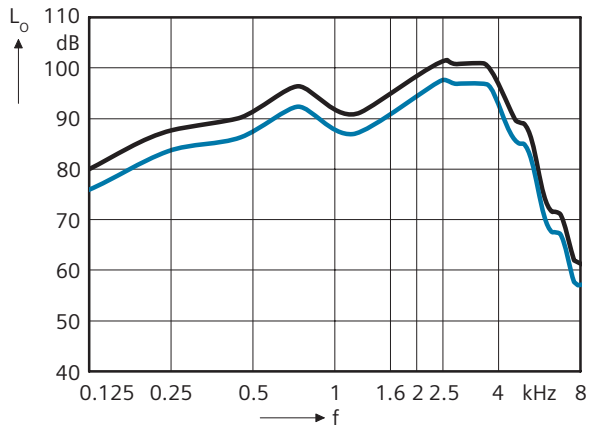

Basic Data w/Standard Earhook

Output Sound Pressure Level ($L_i = 90$ dB)
Maximum Gain ($L_i = 50$ dB)

IEC 118-7/A1; ANSI S3.22-2003

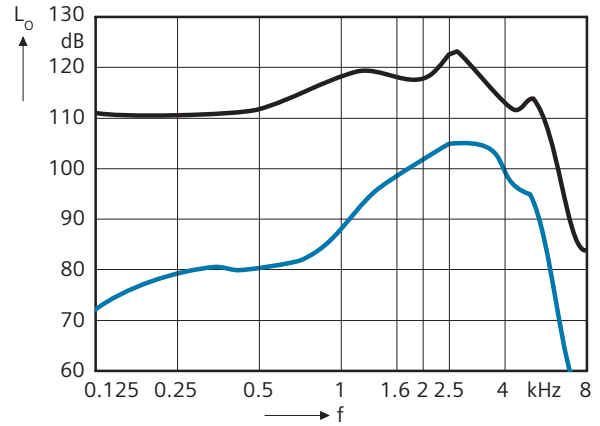

Frequency Response ($L_i = 60$ dB)
Basic Acoustic Response ($L_i = 60$ dB)

IEC 118-7/A1; ANSI S3.22-2003

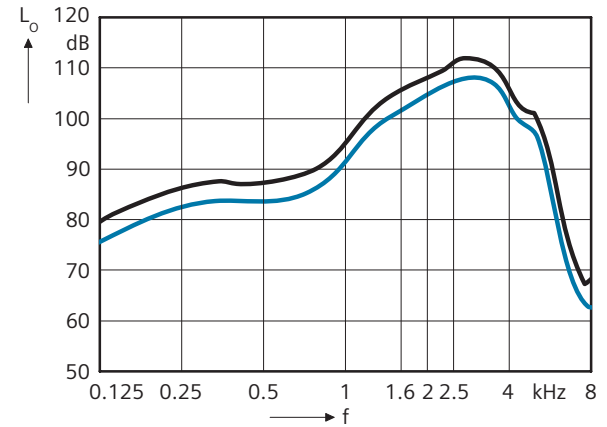

CENTRA Life BTE Fitting Information



Programming Socket

The programming socket lies under a flap below the program button. Use a suitable tool to open the flap. After the programming procedure is complete, close the flap using your fingernail.

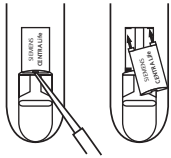

Changing the Typeplates

To mark the left and right side of the CENTRA Life instruments when fitting binaurally, exchange the housing colored typeplates on the inner curve of the instruments for blue (left) and red (right). Use a suitable tool to lift and remove the typeplate. Lock the two pins on the new typeplate into the openings and press gently into position with your finger.

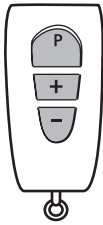

ePocket™

The CENTRA hearing system supports the use of ePocket™, a bi-directional remote control with read out function.

ePocket can change the hearing programs and the volume of CENTRA. The ePocket read out function will display the current program, volume level and battery status of the instrument(s).

ePocket includes a cover and clip.

Life Fitting Set

The Life Fitting Set includes parts and special tools necessary for fitting CENTRA Life in a convenient carrying case. Refills for all parts are available through Siemens.

Siemens Hearing Instruments, Inc. locations

United States Headquarters/Northeast Manufacturing Facility:

10 Constitution Avenue, P.O. Box 1397, Piscataway, NJ 08855-1397 • (732) 562-6600 or (800) 766-4500

Midwest Manufacturing Facility: (847) 808-1200 or (800) 333-9083

West Manufacturing Facility: (562) 404-4531 or (800) 998-9787

Technical Support for Software and Systems: (888) 231-1333

www.usa.siemens.com/hearing

Siemens Hearing Instruments A Division of Siemens Canada Limited

320 Pinebush Road, Cambridge, Ontario, Canada N1T 1Z6 • (519) 622-5200 or (800) 663-0620

Information in this brochure subject to change without notice. © 2006 Siemens Hearing Instruments, Inc. All rights reserved