

CIELO™ Life

Technical Information for Behind-the-Ear Hearing Instruments

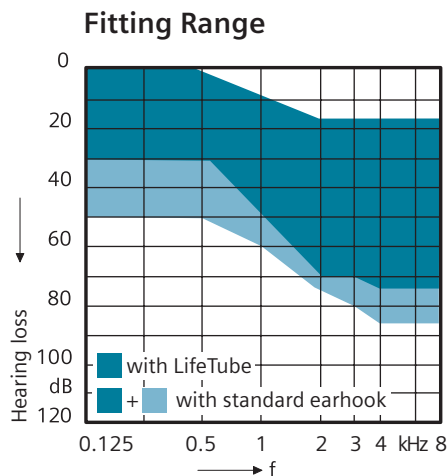

Premium Features

- Fully digital 6-channel automatic micro-BTE instrument
- For mild through moderate hearing loss, ski-slope hearing loss and first time wearers
- Sleek micro-BTE design with no controls on the housing
- Very thin and inconspicuous LifeTube for right and left sides, in various lengths and depths
- Six compression channels with flexible crossover frequencies and 3 adjustable handles
- Automatic feedback cancellation
- Adaptive noise reduction in 6 channels
- Efficient fitting with workflow oriented CONNEXX™ software

Standard Features

- Battery compartment with ON/OFF function
- Audible signal indicator for low battery voltage

Options and Accessories

- Available colors: beige, brown, granite, grey, silver, and translucent
- Life Fitting Set including LifeTips, LifeTubes, LifeTube Selector and other fitting accessories
- Refill sets for Life Fitting Set
- Standard earhook with damper – optional

Standard ANSI S3.22-1996

	Standard Earhook	LifeTube*
Output Sound Pressure Level		
Peak	115 dB	115 dB
HF-Average OSPL 90	111 dB	105 dB
Gain (Input 50 dB)		
Peak	45 dB	35 dB
HF-Average	35 dB	27 dB
Reference test gain	34 dB	27 dB
Frequency Range		
Low frequency limit	140 Hz	100 Hz
High frequency limit	6300 Hz	6300 Hz
Total Harmonic Distortion		
500 Hz	1%	1%
800 Hz	1%	1%
1600 Hz	1%	1%
Equivalent Input Noise	18 dB	18 dB
AGC-O (CK= -21 dB)		
Attack time	3 ms	3 ms
Release time	100 ms	100ms
Battery		
Type	312 cell zinc-air	312 cell zinc-air
Voltage	1.3V	1.3V
Current Drain	0.8 mA	0.8 mA
Typical Life	~190 hrs	~190 hrs

* Measured with LifeTube 2
 Measuring instructions: Instrument in linear setting. Input signal: Sinus Burst; Frequency: 2500 Hz; Low Level: 33 dB; High Level: 60 dB; Interval: 250 ms; On; Time: 125 ms.

Basic Data with LifeTube

Output Sound Pressure Level

ANSI S3.22-1996

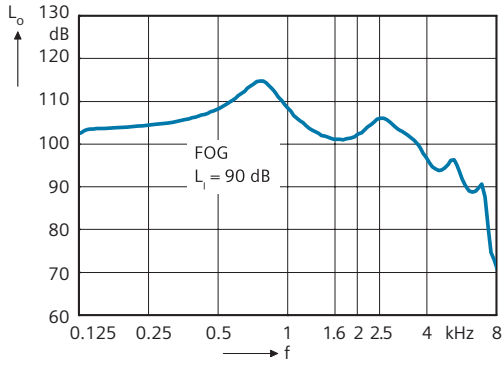

Maximum Gain

ANSI S3.22-1996

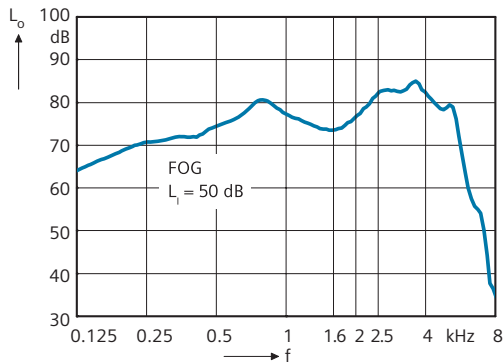

Basic Acoustic Response

ANSI S3.22-1996

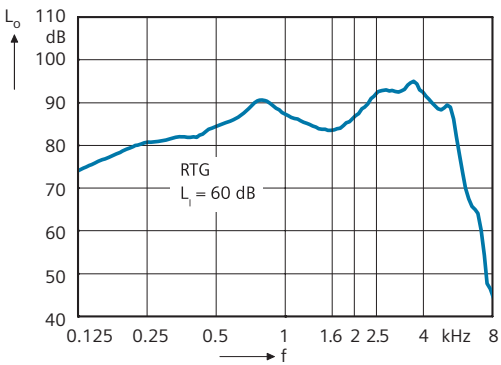

Input/Output Effect of CK-Control

ANSI S3.22-1996

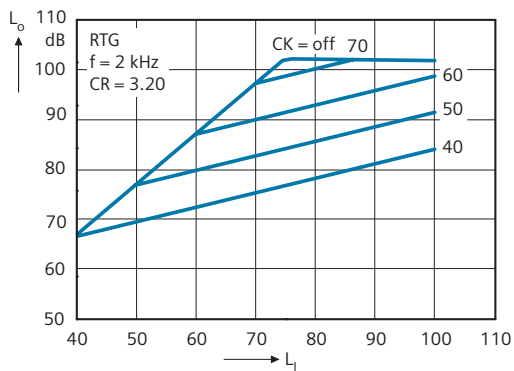

Basic Data with Standard Earhook

Output Sound Pressure Level

ANSI S3.22-1996

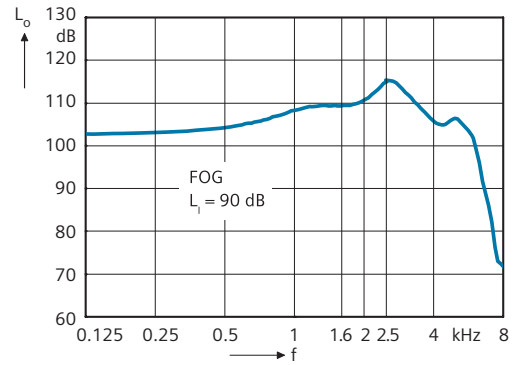

Maximum Gain

ANSI S3.22-1996

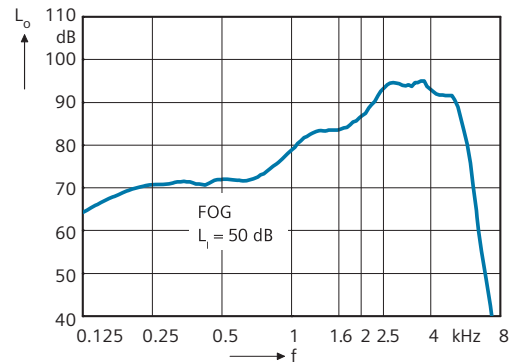

Basic Acoustic Response

ANSI S3.22-1996

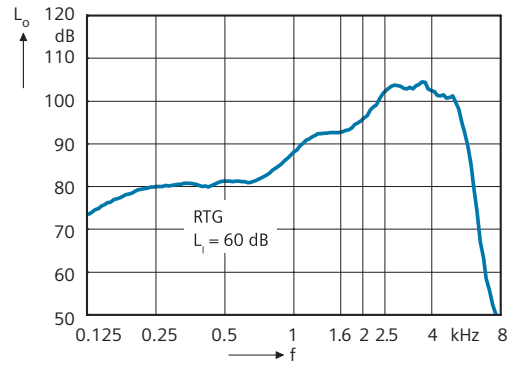

Input/Output Effect of CK-Control

ANSI S3.22-1996

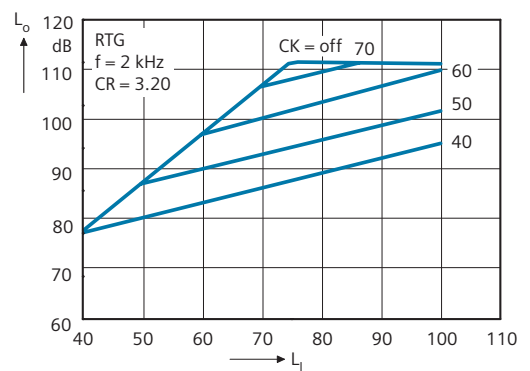

Fitting Information



Programming Socket

The programming socket lies under a flap above the battery compartment. With a suitable tool, open the flap. After the programming procedure is complete, close the flap using your fingernail.

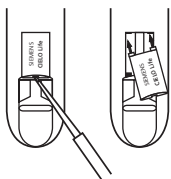

Changing the Typeplates

To mark the left and right side of the CIELO Life instruments when fitting binaurally, exchange the housing colored typeplates on the inner curve of the instruments for blue (left) and red (right). Use a suitable tool to lift and remove the typeplate. Lock the two pins on the new typeplate into the openings and press gently into position with your finger.

Life Fitting Set

The Life Fitting Set includes all parts and special tools necessary for fitting CIELO Life in a convenient carrying case. Refills for all parts are available through Siemens.



Earhook

A traditional dampened earhook is an available option.

Siemens Hearing Instruments, Inc. locations

United States Headquarters/Northeast Manufacturing Facility:

10 Constitution Avenue, P.O. Box 1397, Piscataway, NJ 08855-1397 • (732) 562-6600 or (800) 766-4500

Midwest Manufacturing Facility: (847) 808-1200 or (800) 333-9083

South Manufacturing Facility: (770) 422-4540 or (800) 922-9998

West Manufacturing Facility: (562) 404-4531 or (800) 998-9787

Technical Support for Software and Systems: (888) 231-1333

www.usa.siemens.com/hearing

Siemens Hearing Instruments A Division of Siemens Canada Limited

320 Pinebush Road, Cambridge, Ontario, Canada N1T 1Z6 • (519) 622-5200 or (800) 663-0620

Information in this brochure subject to change without notice. © 2005 Siemens Hearing Instruments, Inc. All rights reserved